

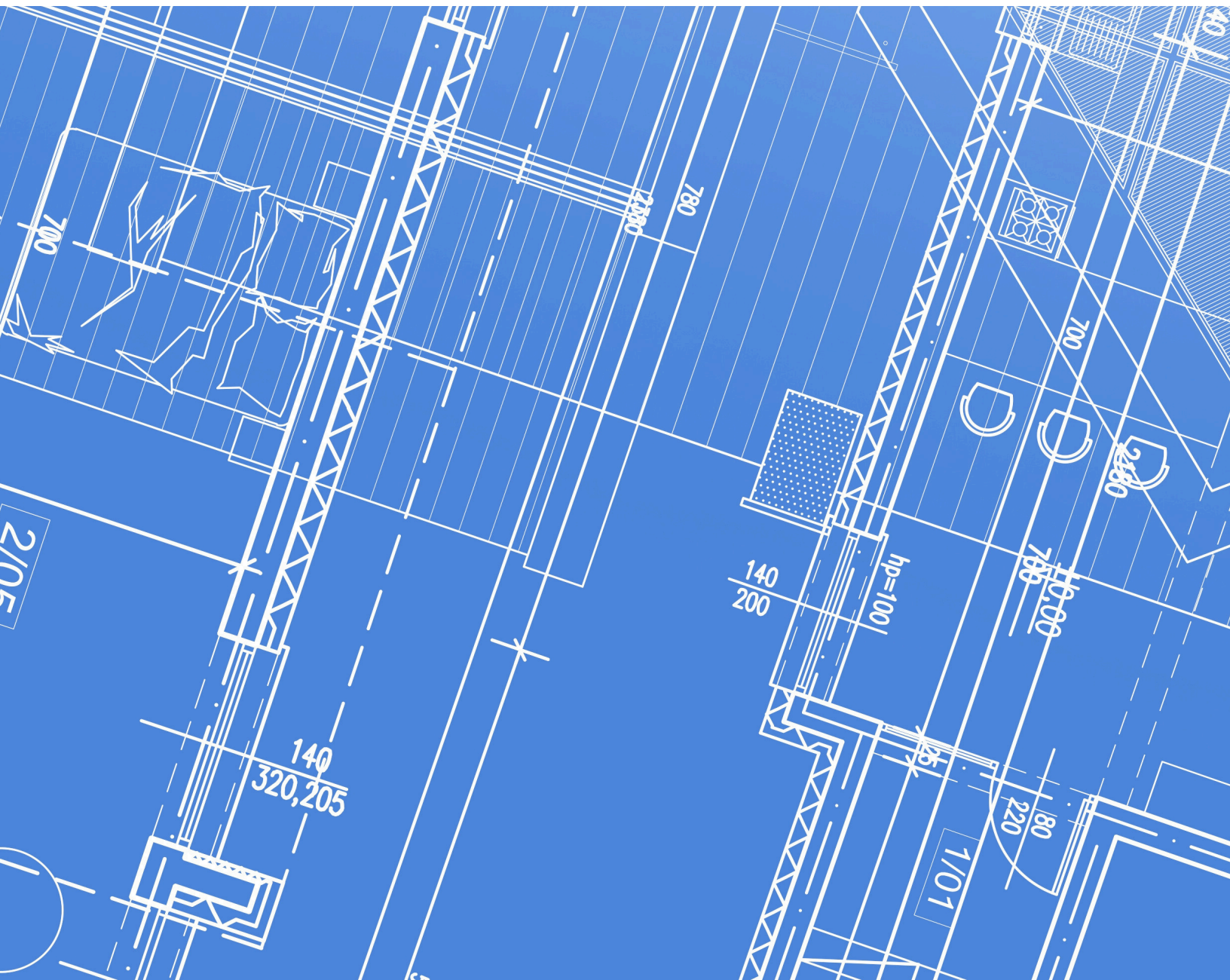

It's time to live into our namesake.
It's time to take another leap of faith.



BUILDING FAITH

Faith UMC

Capital Campaign Guide

OUR CAPITAL CAMPAIGN LEADERSHIP TEAM

David Horton

Lead Pastor

Steven Wise & Brian Alberts

Co-Chairs

Norma Quinn

Horizons Ministry Strategist

Kerri & Dustin Wenzel

Communications

Cynthia Shelton

Affinity Groups

Becca Alberts

Advance Commitments

Julie Vidonic

Prayer

Jeff Bush

Gratitude/Ministry

Frances Planchard

Celebration

Debbie Shaw

Students/Children Leader

Renece Waller-Wise

Coordinator

Special Thanks: Building Committee

Kimberly Duca, Mike Haas, Bo Hudson,
Layne Shelton, Adam Niles, Tina Winter,
Austin Williams, Victoria Ayala,
Julie Vidonic, Dustin Wenzel

Dear Faith Family,

Our vision isn't a building. It's a verb. The vision is **Building faith in Christ for people.**



The Apostle Paul felt the same way. The common purpose for his church, and for our church, is "to equip the saints for the work of ministry, for building up the body of Christ." (Ephesians 4:12). Put simply, *building faith in Christ for people* is why God has a Faith UMC in Spring, Texas. It's not about the Faith building. We're not in the business of making the Faith building prettier. We're about the *business of building faith in Christ* – we want people

to grow upward in their love of God, inward in their faith in Jesus, and outward in their service to the world – *for people*, for the benefit of changed lives, neighbors, and futures. I'm proud of the ways Faith has already lived into this vision in 2025.

- Our concert on April 26 raised over \$4,100 for Hope Center Houston, providing vital services for unhoused neighbors.
- We sent 13 students and 5 adults on a UM ARMY mission trip, all on scholarship.
- We hosted the Prairie View A&M choir on October 5 and collected over \$3,000 for the choir as way of saying thank you.
- The youth group is growing, reaching around 35 students every Wednesday.
- Average weekly worship attendance has grown to 319 people, up from 268 in 2024.
- We'll soon send out 38 Thanksgiving food baskets, each basket containing a Thanksgiving meal for a family in our mission field, and 100 homemade Christmas baskets, each basket containing household necessities for seniors served through Meals on Wheels.

The building projects in the Building Faith campaign are simply the next step of our church's pursuit of our vision. I'm grateful to God that I was able to complete the third pledge card toward this campaign, in addition to my family's annual commitment to Faith. Please join me in giving joyfully, not for a building, but for a verb. Together, let's build faith in Christ for people.

David Horton – Faith UMC Spring Lead Pastor

BUILDING FAITH

Faith UMC

Capital Campaign Guide



Recently, a Sunday School lesson on the book of Ruth posed the question: “If you did a study of your ancestors, what information about them would bless you the most?” The Holy Spirit must have been paying attention, because a single answer immediately leapt into my

mind—my family were all CHURCH BUILDERS! My parents were married in a Methodist church in Willis, Texas that my mother’s family helped to found in the 1800s, and we have continued to build and sustain that church for six generations. As a child, I loved to hear my grandmother’s stories about the long-passed relatives whose names were engraved below the donated stained-glass windows. In that small way, my family tree is still memorialized on the walls of that church. In return, that church has left its mark on my family through the countless baptisms, weddings, and funerals that have knit our generations together for close to 150 years. That church is as much a part of our family as we are a part of it.

A few miles down the road, my father and most of his clan rest in a peaceful clearing in the piney woods, next to County Line Primitive Baptist Church. My grandmother’s grandfather Ambrose started that church in the 1800s, when he donated the land where it now stands. For most of my life, I have not lived within a hundred miles of County Line, but it is still my home. They didn’t need the Methodist Book of Discipline to tell them that a church needed prayers, presence, gifts, service, and witness.

They knew that their churches were the voice and the hands of Christ in the world, and they sustained them for future generations with love and sacrifice. I offer these stories as illustration of what the saints before us felt in their bones: church is family, church is home, church is equal parts past, present, and future.

Faith has been our supportive family and welcoming home since we became members six years ago. We are proud to be part of Faith’s voice of love and compassion, and to know that our hands help Faith lift the burdens of so many. We gladly volunteered to be a part of “Building Faith,” and are excited for the opportunity to grow beyond being church members to being church builders.

It is easy to get lost in the details of blueprints and budgets, so remember that this project is not all about building walls. It is about making the voice of Christ louder and the hands of Christ stronger, by making a home for more youth and more adults as our family grows. It is about finding a way to serve more abundantly in our community.

As you contemplate how you will join us in “building Faith,” I urge you to focus less on how the building will change, and more on how we can best use the building for change. I can’t even imagine the impact that Faith UMC can have 10, 20, or 100 years from now, but the changes we are making today make me excited to find out. If Faith has been a part of your past or present, there is no better time to build its future. We can’t wait to start!

Steven Wise
Co-Chair, Building Faith

BUILDING FAITH

Faith UMC Capital Campaign Guide



What an exciting time for Faith UMC! The growth and energy in our congregation are great to see. I think we've all sensed it, but seeing the attendance figures over the past few years, it is undeniable that our church community is thriving. All the new neighborhoods and population growth in our area provide an opportunity for even more growth and impact.

My family has been attending Faith for a little over 10 years now and we have been fortunate to be a part of this community. We have always enjoyed the worship, but also many great ministries. From the Children's programs to Faith Kids, to the Men's and Women's ministries and the amazing music each Sunday. Our community touches

many people in so many ways.

Personally, I love hearing about the history of the church, from its founding and growth to the relocation to our present building. It's a rich history of worship and service. I'm excited to support the Building Faith campaign to help write the next chapter for our church. Participating in this campaign to renovate our building and prepare for growth will ensure more people can enjoy the many blessings my family has experienced.

Thank you all for your contribution to the history of our community, and please join us as we continue the impact with Building Faith.

Brian Alberts
Co-Chair, Building Faith

OUR HISTORY

Faith was born out of a pioneer spirit to reach new people with the love of Christ. In 1970, our founding generation took a leap of faith: they built the first United Methodist church of Spring and the only United Methodist church on the I-45 corridor between Houston and Conroe.

Our original home was on Sawdust Road, on the west side of I-45, but it was on the east side of I-45 that Spring was booming with new houses and blossoming with young families. Therefore, in 2006, we took a leap of faith: we sold our first building and moved to our current location on Rayford Road. In 2008, Faith built the education building for the expansion of Faith Kids Preschool, and in 2022, Faith sold the portable building where we were holding youth group and built a permanent home for the youth ministry.

For 55 years, the people of Faith United Methodist Church have been living up to our namesake: we take leaps of faith. It's what we do because it's who we are.



THE NEEDS

Now our congregation is fulfilling the wildest dreams of our founders.

- Average worship attendance has more than doubled since 2022 and is currently at 319 people!
- All the rooms in the main building are occupied on Sunday mornings with classes.
- Faith Kids Preschool has reached capacity in the current floorplan of the education building.
- We've run out of storage for the donations we collect to bless our neighbors.
- The youth building can barely contain the number of students on Wednesday nights.

The fact is, our ministry needs for reaching new people with the love of Christ are beyond the capacity of our buildings. **It's time to live into our namesake. It's time to take another leap of faith.**

THE PROPOSAL

The Building Faith campaign is modeled off of three building blocks that build a life of faith in Christ: worship, service, and discipleship. These three areas of ministry represent three fundamental movements, or “leaps,” in the life of a follower of Jesus: we leap upward in worship, we leap outward in service, and we leap inward in discipleship.

There are three ministry goals in the Building Faith campaign, each corresponding with a leap of faith: Awesome Worship, Lead in Service, and Invest in the Young. Each of the seven facility projects in the campaign corresponds with one of the goals.



MINISTRY GOAL 1: AWESOME WORSHIP

Grow average weekly worship attendance to 500 persons by 2030.

PROJECT 1: Remodel the Sanctuary for improvements to sound quality, lighting, flooring, and seating, and a larger chancel for traditional and contemporary worship and the Faith theater ministry.

PROJECT 2: Renovate Common Spaces, including the Narthex, bathrooms, and hallways with new furnishings, signage, lighting, and paint.

PROJECT 3: Transform the Community Room into a true multipurpose space for use by Bible studies, our sewing and outreach ministries, wedding and funeral receptions, and Faith Kids Preschool indoor play.

BUILDING FAITH

Faith UMC

Capital Campaign Guide

MINISTRY GOAL 2: LEAD IN SERVICE

Design intentional spaces for feeding the hungry, supporting local schools, and welcoming community partners.

- **PROJECT 4: Create a Care Closet** for storing food, clothing, school supplies, and other non-perishable items collected by our church for blessing the “least of these.”
- **PROJECT 5: Improve Campus Hospitality** with improvements to outdoor signage and landscaping, and the installation of an indoor sprinkler system, for the sake of welcoming visitors to our campus and the participants in our many outreach ministries.



MINISTRY GOAL 3: INVEST IN THE YOUNG

Expand our children, youth, and Faith Kids Preschool ministries by offering new and larger discipleship ministries.

- **PROJECT 6: Expand Faith Kids Preschool** by transforming the existing reception area into much-needed storage and offices.
- **PROJECT 7: Expand the Youth Building** with three additional classrooms for small group student Bible study and a warm, inviting feel in the main hall.

BUILDING FAITH

Faith UMC

Capital Campaign Guide



OUR CHOICE

The total cost of all the Building Faith projects is anticipated to be \$1.5 million. Our building committee is working with Merriman Holt Powell architects on a full set of detailed plans and is soliciting bids from contractors. The work may begin in 2026, as soon as the first gifts to the campaign are received and a called Church Conference approves the execution of the projects. Building Faith will be funded by three-year pledges to be completed over and above our gifts to the annual operating budget.

Now is the time to take the next leap of faith. Please consider making your pledge to the Building Faith campaign. Also, please pray for the people of Faith United Methodist Church, that God the Father would provide all we need to achieve our mission of growing in faith to love like Jesus, that God in Christ would call us upward, outward, and inward to become more like Him, and that God the Spirit would use us to build out heaven on earth.



WAYS YOU CAN GIVE

There are multiple payment methods to use for your pledge to the Building Faith capital campaign.



Cash or Check

Choose a one-time gift or spread your pledge out across three years in installments.



ACH / Debit Card / Credit Card

Pay through our donation site. Credit card incurs a processing fee; debit/ACH incurs no fee and is the preferred method.



Other Appreciated Assets

Stocks, mutual funds, bonds, and real estate have tax advantages.



Charitable Rollovers

Give up to \$100,000 if you're age 70.5 or older. See the Giving Strategies page for more details.

FREQUENTLY ASKED QUESTIONS

How were these projects selected?

In the spring of 2025, a new building committee comprised of eight representatives from the congregation met with Pastor David and the church staff. After several meetings, a building tour, two discussions with our architects, and consideration on a larger capital campaign for a new community space, the team narrowed our capital campaign scope to these seven immediate needs listed in this guide.

What's our priority among the seven projects?

The education building is as important as the narthex, which is as important as the youth building, which is as important as the sanctuary. We intend to complete all of these projects. The work may not be completed in the priority order, but instead to limit disruptions to services and normal operations of the church and Faith Kids Preschool.

What happens if we don't make our capital campaign goal?

We believe the congregation is ready and willing to commit to funding 100% of the cost necessary to make these renovations. If we do not hit our fundraising target, the building committee will examine ways to reduce costs. If it chooses, our OneBoard has the ability to take on some debt and borrow funds from The Texas Methodist Foundation. The debt service would then have to be funded by our annual operating budget and any additional fundraising efforts.

How do I give other than cash gifts?

- For more information on how to give stocks, mutual fund shares, and bonds, please contact Patricia Martin, Director of Finance, at patricia@faithumcspring.org.
- For specific or confidential questions, you should also contact your financial planner, CPA, or tax expert.

Am I eligible to donate through a charitable rollover?

People aged 70.5 and over can give through charitable IRA rollovers from traditional or Roth IRAs. A total of up to \$108,000 can be transferred directly to the church and is free from federal income tax. Amounts given in this way count toward required IRA minimum withdrawal amounts for the year of the gift. It's always a good idea to check with your money manager on this option.

Who do I contact for more details?

Contact Pastor David at david@faithumcspring.org or Patricia at patricia@faithumcspring.org. You can also reach both at 281-367-7776.

NOTE: Any discussion of tax treatment is not intended and should not be considered as tax advice. Consult your personal tax professional for advice on your tax position.

BUILDING FAITH

Faith UMC

Capital Campaign Guide

How Your Family Can Play a Role in the Future

Every gift plays a significant role toward reaching our fundraising goal of \$1.5 million.

To assist you on how your pledge can fit into your family's budget, the chart on the right demonstrates how a small gift each month can lead to a large impact to the campaign, and ultimately, our ability to further Faith's mission.

When your family prayerfully considers your pledge, think about which building block you can fill in the pyramid of givers below. Each donor is incredibly important to the success of the campaign and the growth of the church.

WEEKLY	ANNUALLY	3-YEAR GIFT
\$32.05	\$1,600	\$5,000
\$48.07	\$2,500	\$7,500
\$76.92	\$4,000	\$12,000
\$96.15	\$5,000	\$15,000
\$134.61	\$7,000	\$21,000
\$192.30	\$10,000	\$30,000

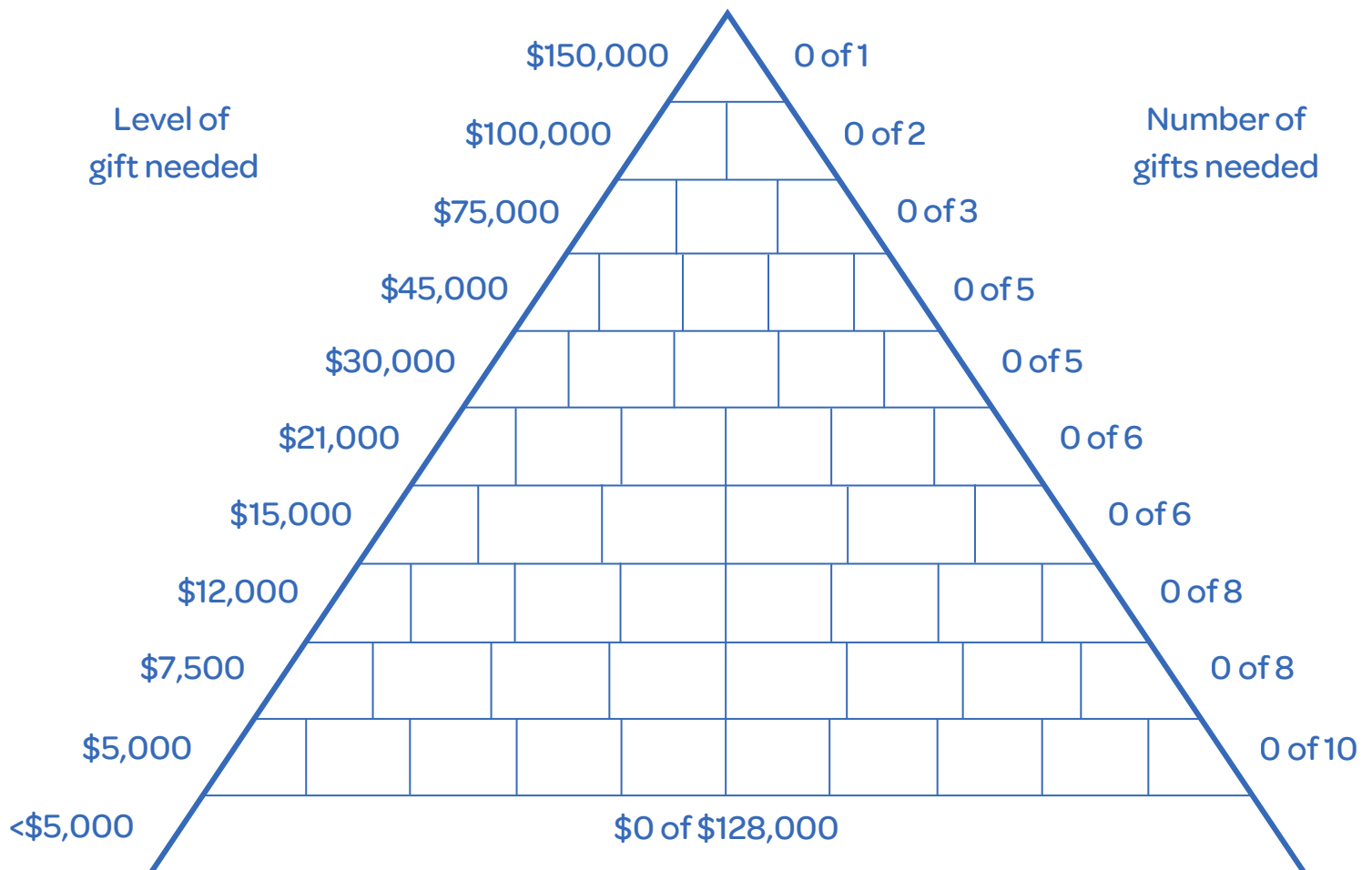

What's Next...

1

Look For Your Commitment Card in the Mail

A Commitment Card for our Capital Campaign will be sent to your address on file in the coming weeks.

2

Complete Your Pledge Cards

Prayerfully discern how your family can contribute to our annual budget in 2026 and our three-year capital campaign, and fill out both cards.

3

Join Us for Commitment Sunday on January 4

Bring in your Annual Pledge Card and Campaign Commitment Card to service on the first Sunday of 2026 to kick off a year of progress.

